

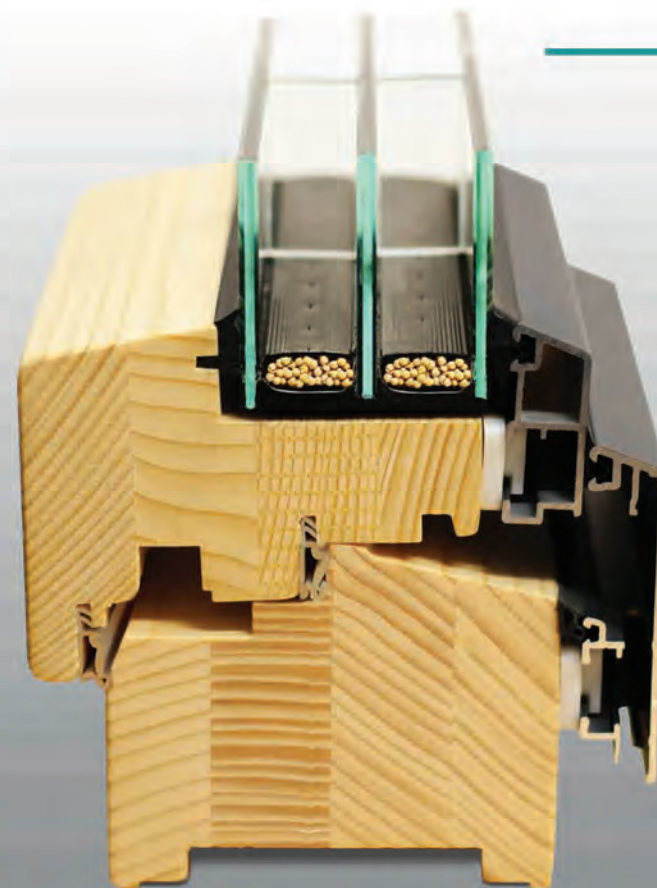

In the **Jankó\_CROSS<sup>+</sup>** window, the warmth of the wood meets with the clarity and dignity of the aluminium.



THE MEETING OF THE OBLIQUE AND ANGULAR SHAPES, DESIGNED FOR TODAY'S MODERN HOUSES.

**DESIGN**

FOR ANYONE!

#### AVAILABLE DESIGNS

- ◆ WINDOW
- ◆ LIFT AND SLIDE
- ◆ FIX
- ◆ ENTRANCE DOOR
- ◆ TILT AND SLIDE

SYNCHRONIZED DESIGN, HIGH-  
TONED COMPLEXITY TOGETHER  
WITH INDIVIDUAL IDEAS.



WWW.JANKOABLAK.HU

THIS IS HOW WE CREATED THE



BROAD SYSTEM

FROM DREAM TO REALITY

- ◆ *DIAGONAL DESIGN*
- ◆ *OUTSTANDING GOOD VALUES*
- ◆ *HIGH TECHNICAL CONTENT*
- ◆ *SECURITY OPTION*
- ◆ *COMFORTABLE, EASY USAGE*

WWW.JANKOABLAK.HU

- ▶  $UW = 0,78 \text{ W/M}^2 \text{ K}$
- ▶  $UG = 0,5 \text{ W/M}^2 \text{ K}$
- ▶  $G = 49,4 \%$
- ▶  $TE = 41,8 \%$
- ▶  $PSI = 0,043 \text{ W/M}^2 \text{ K}$



**MATERIAL:**  
- PINE  
- OAK  
- EUCALYPTUS



**GLASS:**  
48 MM TRIPLE GLAZING, FILLED  
WITH ARGON GAS



**ALUMINIUM:**  
ALUMINIUM CLIP SYSTEM,  
MASSIVE, STRONG HOLD



**SEAL:**  
4X SEAL



**FITTINGS:**  
30 MM LOCKING PLATES  
FOR SECURITY



**PREPARATION:**  
IT CAN BE INTEGRATED INTO  
CUSTOM SYSTEMS



**Jankó\_CROSS<sup>+</sup>**



ADVANCED TECHNICAL SOLUTIONS,  
OPPORTUNITIES FOR USER-FRIENDLY  
PRODUCTS, FOR YOU!



In the **Jankó\_CROSS+ flat** window, the warmth of the wood meets with the clarity and dignity of the aluminium.

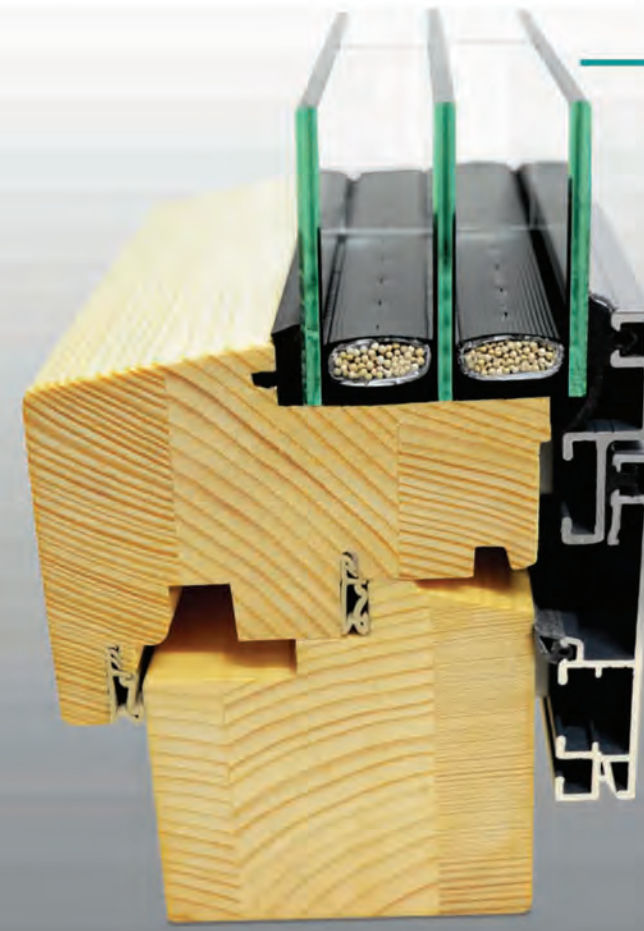

SYNCHRONIZED DESIGN, NARROW PLANES, HIGH-TONED COMPLEXITY DESIGNED FOR TODAY'S MODERN HOUSES.

**DESIGN**  
FOR ANYONE!

- AVAILABLE DESIGNS
- ◆ WINDOW
  - ◆ LIFT AND SLIDE
  - ◆ FIX
  - ◆ ENTRANCE DOOR
  - ◆ TILT AND SLIDE

SYNCHRONIZED DESIGN, NARROW PLANES,  
HIGHTONED COMPLEXITY DESIGNED FOR  
TODAYS MODERN HOUSES.



WWW.JANKOABLAK.HU

THIS IS HOW WE CREATED THE

*Jankó*\_CROSS<sup>+</sup> flat



BROAD SYSTEM

DESIGN FOR ANYONE

- ◆ FLUSH-FITTING PROFILE
- ◆ THE MEETING OF ANGULAR LINES
- ◆ MINIMALIST EXTERIOR DESIGN
- ◆ DIAGONAL INNER SURFACE
- ◆ NARROW SASH

WWW.JANKOABLAK.HU

- ▶  $UW = 0,78 \text{ W/M}^2 \text{ K}$
- ▶  $UG = 0,5 \text{ W/M}^2 \text{ K}$
- ▶  $G = 49,4 \%$
- ▶  $TE = 41,8 \%$
- ▶  $PSI = 0,043 \text{ W/M}^2 \text{ K}$



**MATERIAL:**  
- PINE  
- OAK  
- EUCALYPTUS



**GLASS:**  
48 MM TRIPLE GLAZING, FILLED  
WITH ARGON GAS



**ALUMINIUM:**  
ALUMINIUM CLIP SYSTEM,  
MASSIVE, STRONG HOLD



**SEAL:**  
4X SEAL



**FITTINGS:**  
30 MM LOCKING PLATES  
FOR SECURITY



**PREPARATION:**  
IT CAN BE INTEGRATED INTO  
CUSTOM SYSTEMS



**Jankó\_CROSS<sup>+</sup> flat**



ADVANCED TECHNICAL SOLUTIONS,  
OPPORTUNITIES FOR USER-FRIENDLY  
PRODUCTS, FOR YOU!



In the **Jankó\_CROSS<sup>+</sup> duo flat** window, the warmth of the wood meets with the clarity and dignity of the aluminium.

NEW!

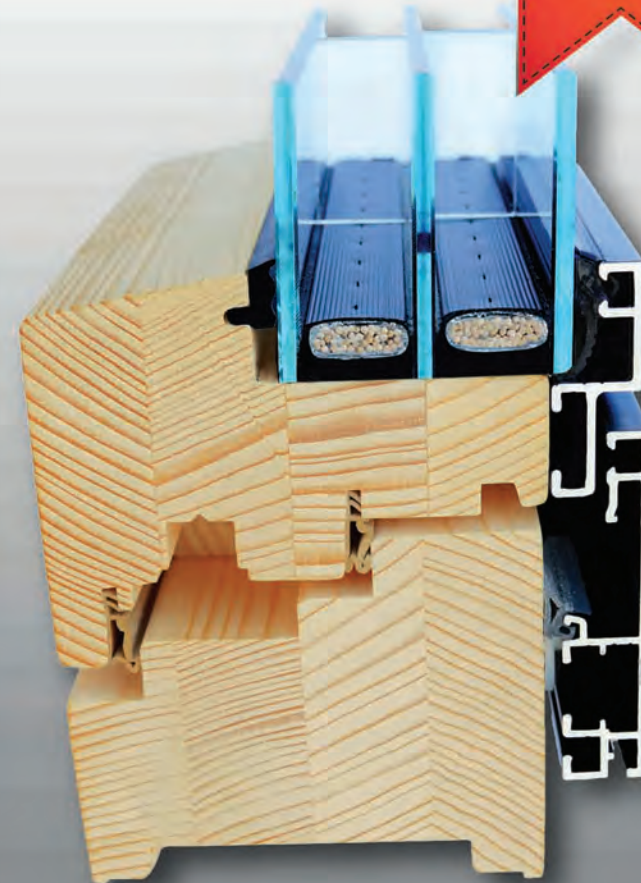

FLUSH-FITTING PROFILE INSIDE AND OUTSIDE. REFINED, PERSONALIZED DESIGN.

DESIGN

FOR ANYONE!

AVAILABLE DESIGNS

◆ WINDOW

◆ FIX



SYNCHRONIZED DESIGN. HIGH-TONED COMPLEXITY TOGETHER WITH INDIVIDUAL IDEAS.

WWW.JANKOABLAK.HU

THIS IS HOW WE CREATED THE

 Jankó\_CROSS<sup>+</sup> duo flat

FROM DREAM TO REALITY

- ◆ REFINED ARCHITECTURAL ELEMENT
- ◆ FLUSH-FITTING PROFILE
- ◆ UNIQUE INTERIOR DESIGN
- ◆ NARROW SASH PROFILE
- ◆ FLAT OPTICS

- ▶  $UW = 0,78 \text{ W/M}^2 \text{ K}$
- ▶  $UG = 0,5 \text{ W/M}^2 \text{ K}$
- ▶  $G = 49,4 \%$
- ▶  $TE = 41,8 \%$
- ▶  $PSI = 0,043 \text{ W/M}^2 \text{ K}$



**MATERIAL:**  
- PINE  
- OAK  
- EUCALYPTUS



**GLASS:**  
48 MM TRIPLE GLAZING, FILLED  
WITH ARGON GAS



**ALUMINIUM:**  
ALUMINIUM CLIP SYSTEM,  
MASSIVE, STRONG HOLD



**SEAL:**  
4X SEAL



**FITTINGS:**  
30 MM LOCKING PLATES  
FOR SECURITY



**PREPARATION:**  
IT CAN BE INTEGRATED INTO  
CUSTOM SYSTEMS

★  
**NEW!**

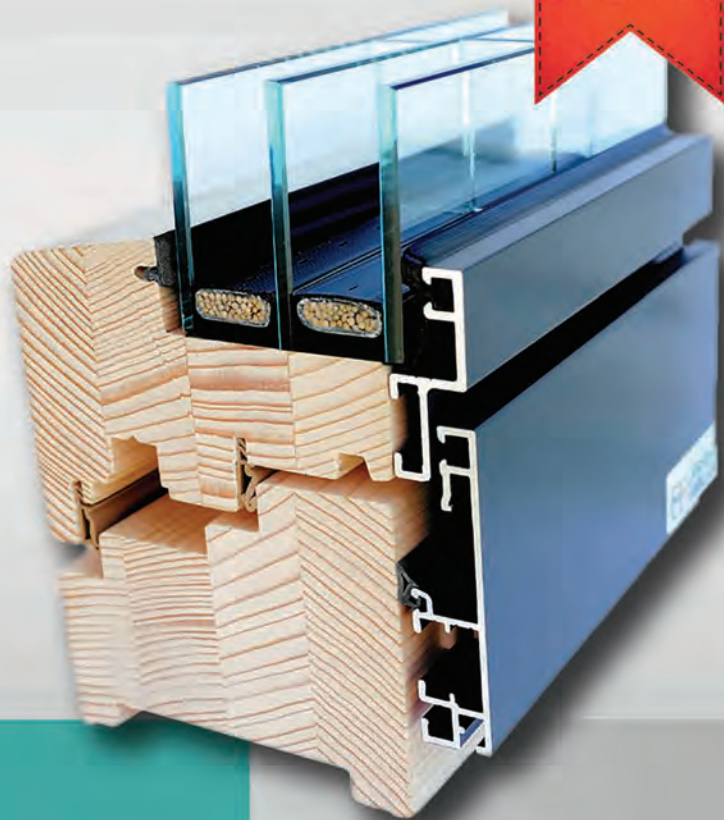

**Jankó**\_CROSS+ duo flat



ADVANCED TECHNICAL SOLUTIONS,  
OPPORTUNITIES FOR USER-FRIENDLY  
PRODUCTS, FOR YOU!

# TREND 2017

PRECIOUS WOOD COVERED SURFACE



- ◆ *Natural effect on the elements of the window*
- ◆ *Customizable product line*
- ◆ *Precious wood surface perceptible in both opened and closed condition*
- ◆ *Matte surface finishing*

*Interior design comes alive!*

**DESIGN | EXCLUSIVE APPEARANCE**



AVAILABLE DESIGNS

CROSS

FLAT

DUO FLAT

EUCALYPTUS

SPRUCE

LARCH

OAK

CHERRY

SURFACES

# ALUMINIUM COLOUR SWATCHES

COLOUR/SURFACE/STRUCTURE

MAIN COLOURS



PREMIUM MATTE BASE COLOURS



SURCHARGE COLOURS

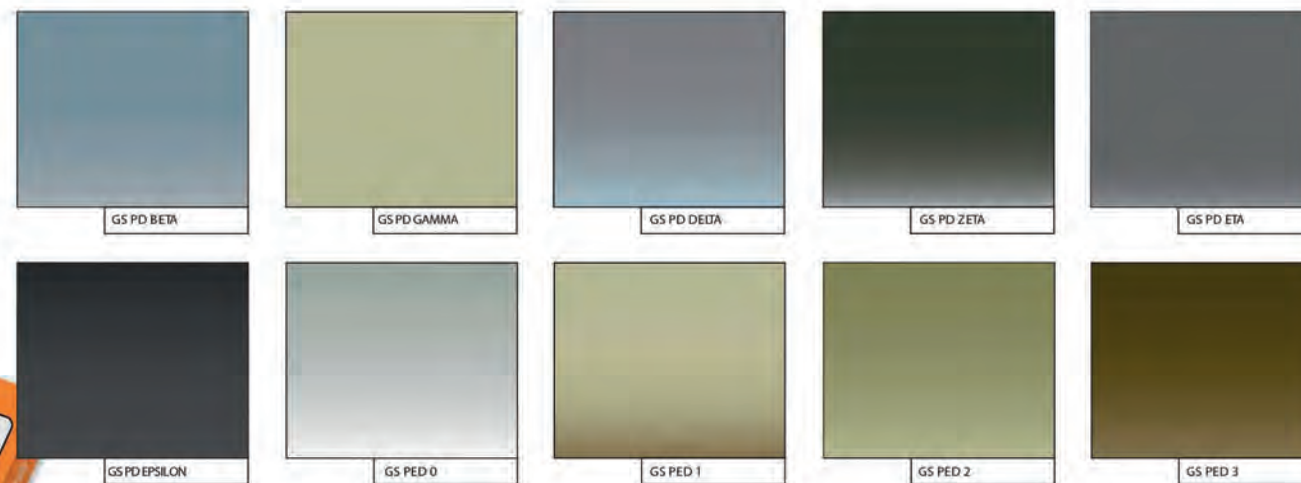

WOOD GRAINED ALUMINIUM SYSTEMS



TIP: PREMIUM MATTE BASE COLOURS ARE AVAILABLE IN MATTE STRUCTURED MAKE AS WELL, STRONGER SURFACE AND MORE SCRATCH-PROOF. SURCHARGE VERSION.

# ENTRANCE DOORS - ALUMINIUM DOOR FORMS



*Jankó*\_OSL



*Jankó*\_TOR



*Jankó*\_STO



*Jankó*\_STR



*Jankó*\_TOK



*Jankó*\_VEN



*Jankó*\_HAM



*Jankó*\_LON



*Jankó*\_NEW



*Jankó*\_DUB



**GS** **STEMESEDER**  
Schnell. Sicher. Stemeseder.

*Jankó*\_PRA



*Jankó*\_BAS



*Jankó*\_BER



*Jankó*\_ROM



IDEA: CONTRAST CAN STAND OUT BETTER ON A DOOR IF WE USE A NUMBER OF DIFFERENT TONED AND COLOURED ALUMINIUM.  
TIP: THE ENTRANCE DOOR CAN BE DIFFERENT COLOURED FROM THE WINDOWS.

The external window blinds are the most effective and power saving way to the buildings to prevent overheating.

However, the blinds, louvres and others can do more: while it operates as a passive cooling system in the summer, they enhance the insulation properties of the fenestration and let through the precious anti-dazzle sunshine to the interior space throughout the year.

The **intelligent shading systems** are essential elements of our current housing, and it cannot be missed from the negotiations about climate protection and energy conservation.



### What kind of louvre should I choose, what might be right for me?

- ◆ An intelligent shading system that operates as a passive cooling system in summer and they enhance the insulation properties of the fenestration in winter.
- ◆ A system, which can bring in guided, anti-dazzle light to the island of our dreams, thus it increases our comfort and performance.
- ◆ Louvres that can be driven by a wall mounted switch or radio control and they satisfy every need.
- ◆ Optical features, which can be characteristics of our house, for example, completely hidden louvre boxes, or even matching coloured hang strips, louvres and aluminium armour on the window.
- ◆ Louvre blade version, which fits for its purpose and intended function whether it is classified based on its width: 80 mm or 92 mm; based on its form: "C" louvre blade; broken "Z" louvre blade 92 V, or our asymmetrically broken premium system, the retrolux 80 D louvre blade.
- ◆ Such a superstructure, where the visible or plasterable edges can be selected, or the systems can be combined with pushing-, sliding- and fix mosquito and insect nets.
- ◆ Against the first pollens of the spring, we recommend the 4PLUS pollen filtered mosquito nets, which let more light and air in than the others, gives better pollen filtering and better transparency.

### COLOURS FOR EVERY STYLE



RETRO LUX 80 D



80 R



92 V

#### Retrolux 80 d louvre blade

- Colourless (similar to RAL 9006)
- RAL 9006\*
- RAL 9007\*

\* reduced light navigation function  
\*\* Matt light grey bottom side

#### 80r/92v louvre blade

- RAL 7038 Agate grey
- RAL 9006 White aluminium
- RAL 9007 Grey aluminium
- RAL 9016 White
- RAL 7016 Anthracite grey
- RAL 7047 Medium grey
- RAL 1015 Ivory
- NCS S2010-Y30R Light beige
- RAL 3004 Magenta
- RAL 6005 Moss green

# INSTALLATION SITUATION

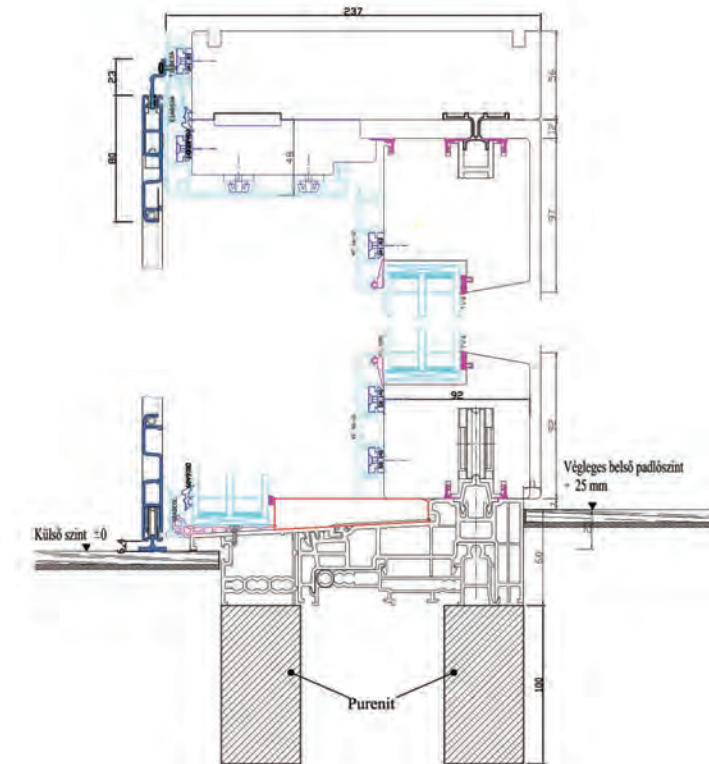
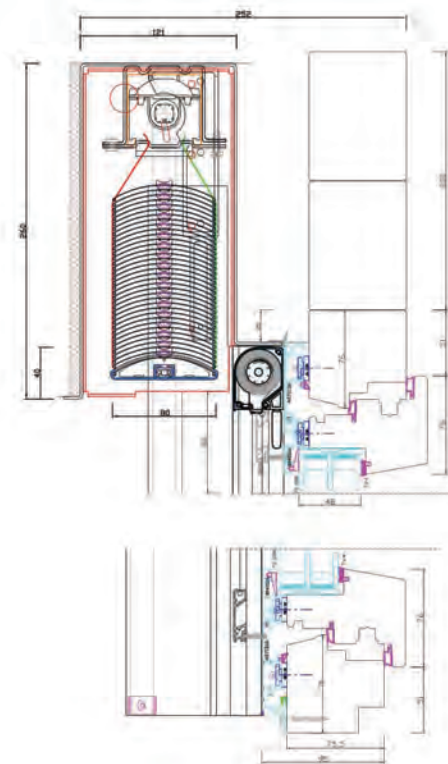
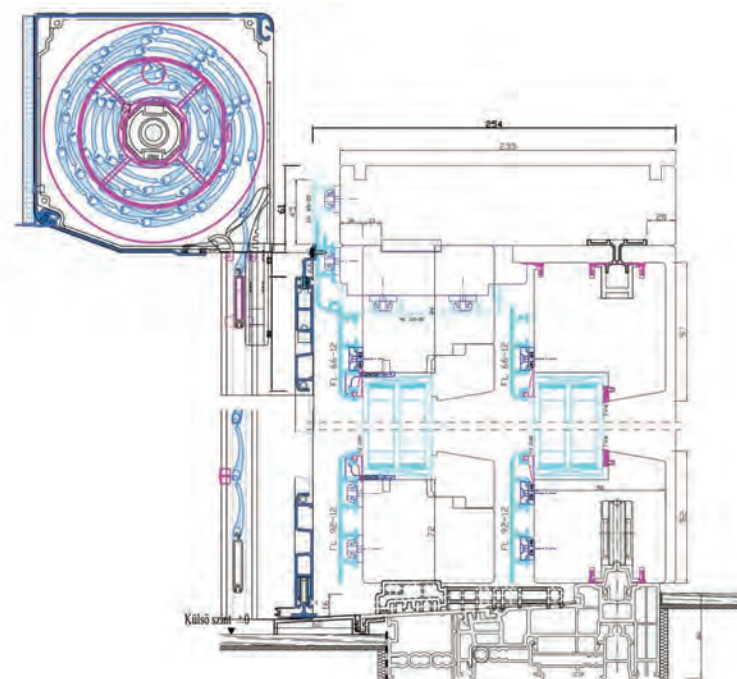
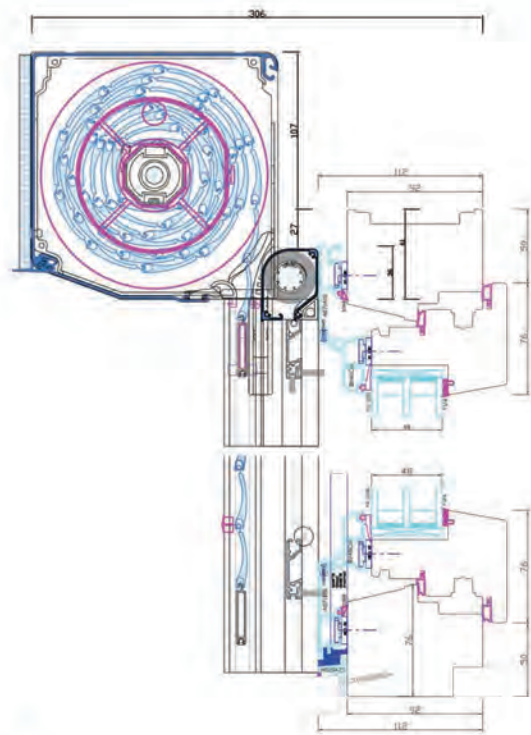

## INSTALLATION NODE

- Type: Jankó\_Cross window, Voro Putz plasterable shutter
- Louvre: Alu Blades
- Supplementary: Integrated 'click' blind



## INSTALLATION NODE

- Type: Jankó\_Cross lift and slide, Voro Putz plasterable shutter
- Louvre: Alu Blades
- Supplementary: Integrated B framed pushing net



## INSTALLATION NODE

- Type: Jankó\_Cross Flat window, Raff S Raffstore
- Louvre: 80 C Blades
- Supplementary: Integrated 'click' blind



## INSTALLATION NODE

- Type: Jankó\_Cross lift and slide
- Supplementary: Integrated B framed pushing net

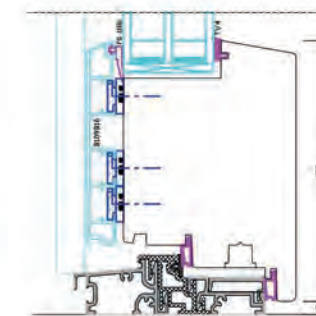
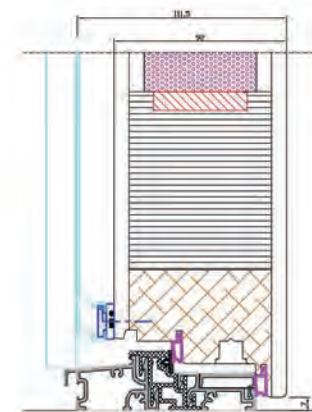
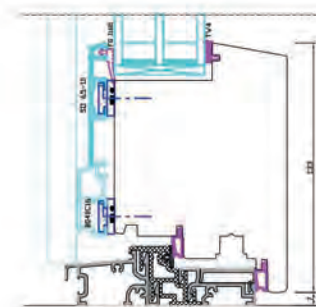
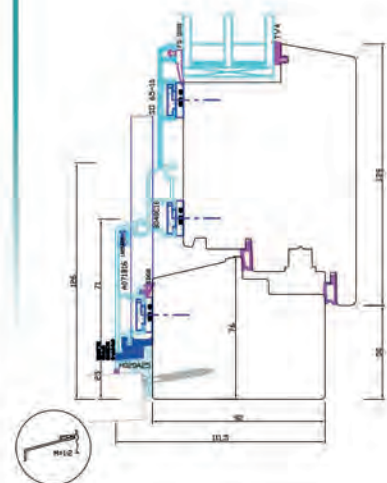
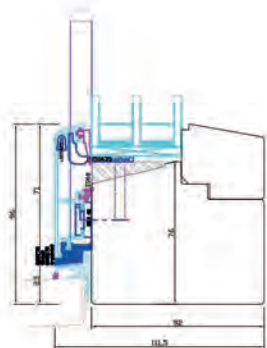
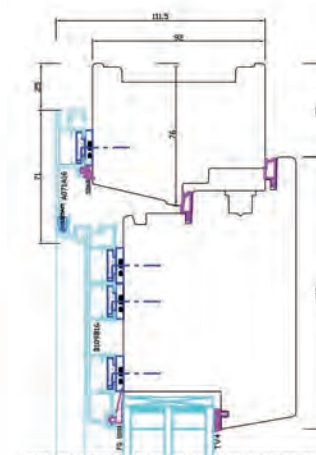
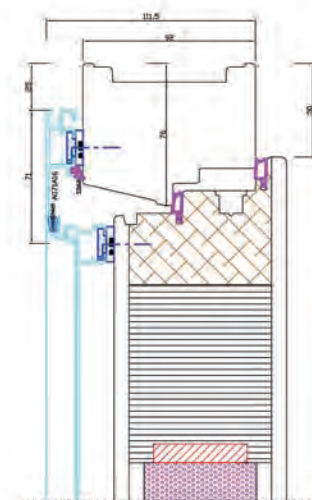
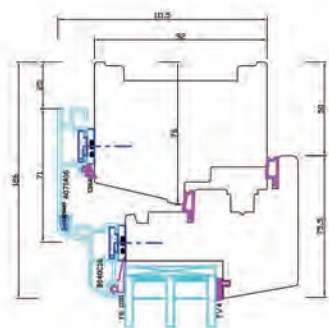
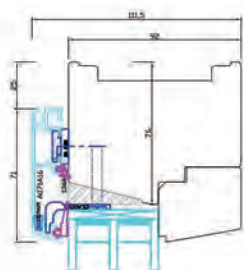

FIX SECTION

WINDOW SECTION

BALCONY DOOR SECTION

ALUMINIUM THRESHOLD  
BALCONY DOOR  
SECTION

FLAT DOOR  
SECTION

PANELLED FRAME  
DOOR SECTION



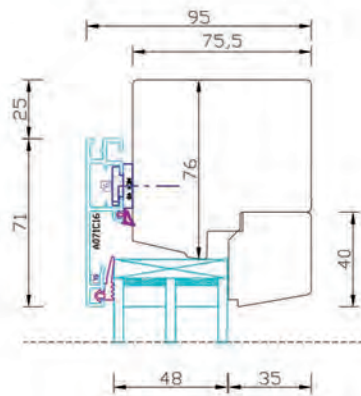

FIX SECTION

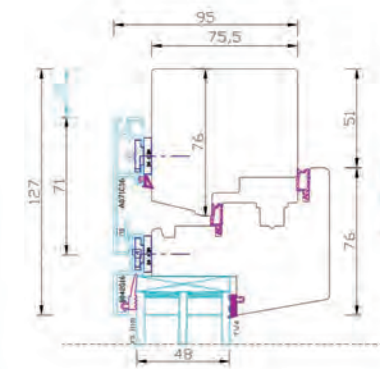

WINDOW SECTION

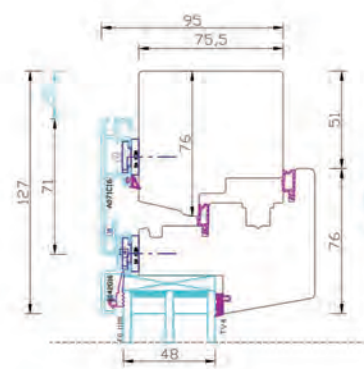

BALCONY DOOR SECTION



ALUMINIUM THRESHOLD  
BALCONY DOOR  
SECTION

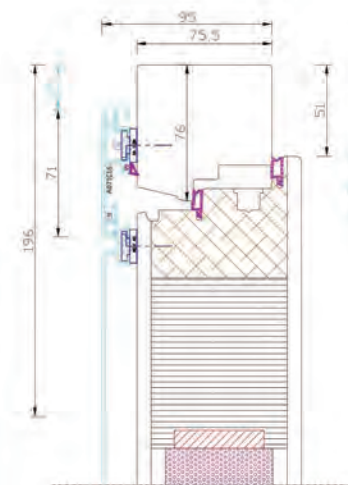

FLAT DOOR  
SECTION

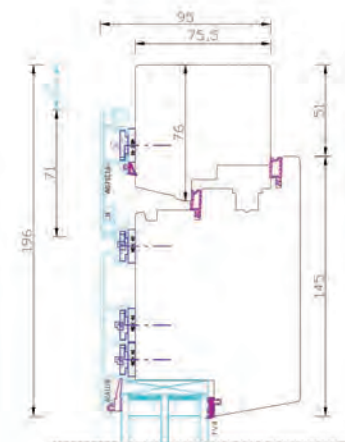

PANELLED FRAME  
DOOR SECTION

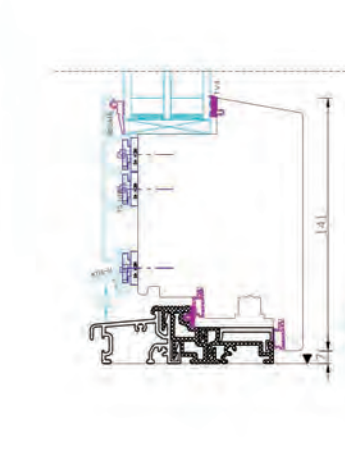
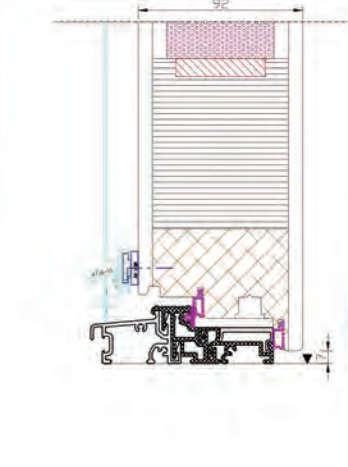
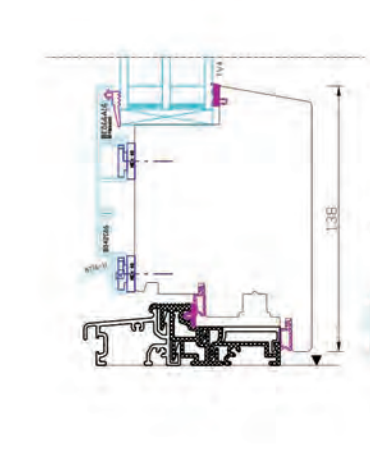
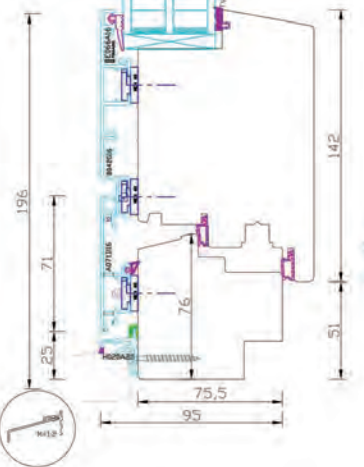
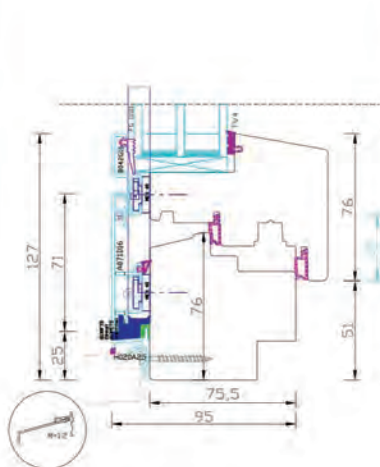
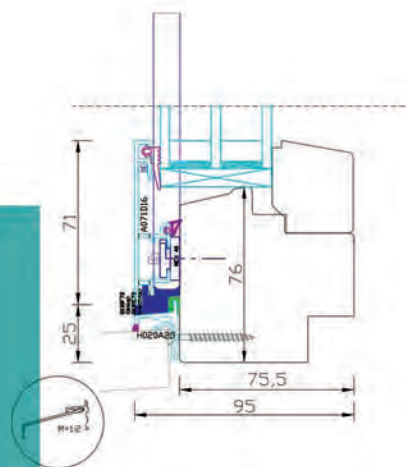

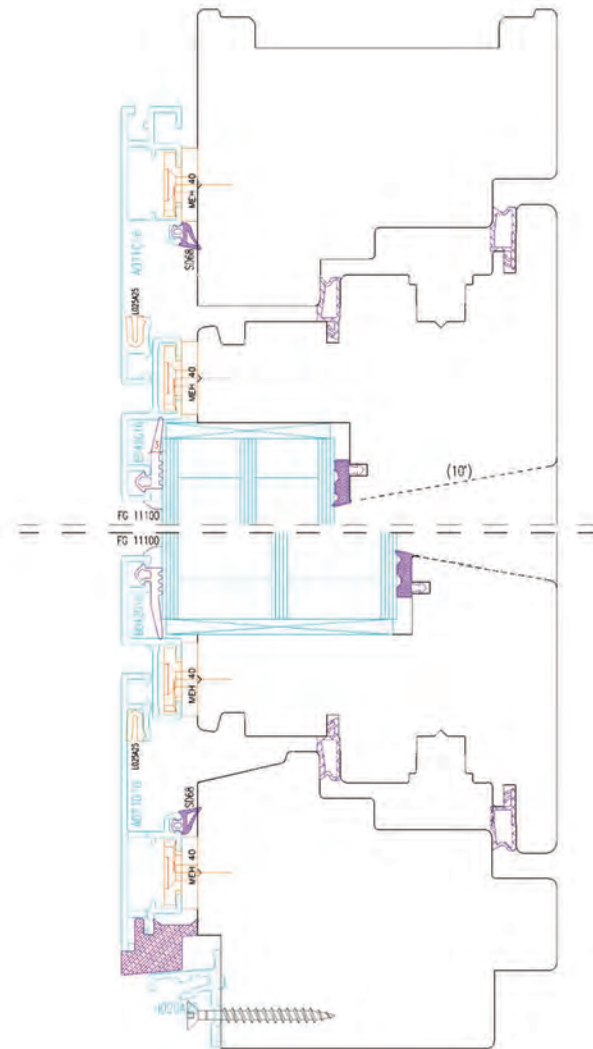

**FIX SECTION**





### **Jankó Faipari és Kereskedelmi Kft.**

Address: 23. Ország road, Szigetvár H-7900  
Phone: +36-73-510-177  
Fax: +36-73-510-286  
Mobile: +36-30-500-8938  
Website: [www.jankokft.hu](http://www.jankokft.hu)  
E-mail: [info@jankokft.hu](mailto:info@jankokft.hu)

### **Showroom:**

Address: 6-8. San Marco street, Budapest III.  
Phone/Fax: +36-1-437-0102  
Mobile: +36-30-427-8499  
E-mail: [pest@jankokft.hu](mailto:pest@jankokft.hu)

Address: 502. Üllői road, Budapest XVIII.  
Phone: +36-1-297-0322  
Fax: +36-1-297-0323  
Mobile: +36-30-563-6769  
E-mail: [ulloi@jankokft.hu](mailto:ulloi@jankokft.hu)

Address: 47. Budapest road, Veszprém  
Mobile: +36-20-947-2414  
E-mail: [veszprem@jankokft.hu](mailto:veszprem@jankokft.hu)

Address: 9. Zarándok road, Sopron  
Mobile: +36-20-418-9591  
E-mail: [info@jankofenster.at](mailto:info@jankofenster.at)

**Your Jankó Window trader:**



[WWW.JANKOABLAK.HU](http://WWW.JANKOABLAK.HU)

We don't take responsibilities for the typographical errors.